

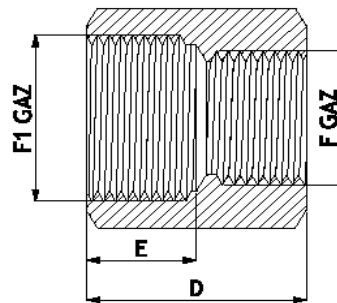

- Acier Inoxydable 316L
- Taraudage GAZ Cylindrique selon NFE 03005
- Entièrement usiné
- Pression de service 80 bars
- Température : jusqu'à 300°C

- AISI 316L Stainless steel
- BSPP Threaded
- Machined
- Pressure : 1000 PSI
- Temperature : up to 572°F

### RFF REDUCTION FEMELLE FEMELLE REDUCER SOCKET

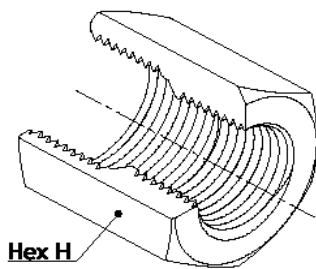

| REF       | D    | E    | F    | F1   | H      | Poids (kg) |
|-----------|------|------|------|------|--------|------------|
| RFF 08-05 | 20,0 | 11,0 | 1/8" | 1/4" | 17     | 0,023      |
| RFF 12-05 | 25,0 | 11,0 | 1/8" | 3/8" | 22     | 0,056      |
| RFF 12-08 | 25,0 | 12,0 | 1/4" | 3/8" | 22     | 0,051      |
| RFF 15-05 | 29,0 | 15,0 | 1/8" | 1/2" | 27     | 0,097      |
| RFF 15-08 | 29,0 | 15,0 | 1/4" | 1/2" | 27     | 0,093      |
| RFF 15-12 | 29,0 | 15,0 | 3/8" | 1/2" | 27     | 0,084      |
| RFF 20-05 | 31,0 | 15,0 | 1/8" | 3/4" | Ø35/27 | 0,134      |
| RFF 20-08 | 31,0 | 15,0 | 1/4" | 3/4" | Ø35/27 | 0,125      |
| RFF 20-12 | 31,0 | 15,0 | 3/8" | 3/4" | Ø35/27 | 0,116      |
| RFF 20-15 | 31,0 | 15,0 | 1/2" | 3/4" | Ø35/27 | 0,088      |
| RFF 25-08 | 33,0 | 17,0 | 1/4" | 1"   | Ø40/34 | 0,169      |
| RFF 25-12 | 33,0 | 17,0 | 3/8" | 1"   | Ø40/34 | 0,161      |
| RFF 25-15 | 33,0 | 17,0 | 1/2" | 1"   | Ø40/34 | 0,146      |

| REF       | D    | E    | F      | F1     | H      | Poids (kg) |
|-----------|------|------|--------|--------|--------|------------|
| RFF 25-20 | 33,0 | 17,0 | 3/4"   | 1"     | Ø40/34 | 0,118      |
| RFF 32-12 | 35,0 | 17,0 | 3/8"   | 1 1/4" | Ø49/40 | 0,254      |
| RFF 32-15 | 35,0 | 17,0 | 1/2"   | 1 1/4" | Ø49/40 | 0,233      |
| RFF 32-20 | 35,0 | 17,0 | 3/4"   | 1 1/4" | Ø49/40 | 0,207      |
| RFF 32-25 | 35,0 | 17,0 | 1"     | 1 1/4" | Ø49/40 | 0,165      |
| RFF 40-15 | 39,0 | 20,0 | 1/2"   | 1 1/2" | Ø54/50 | 0,348      |
| RFF 40-20 | 39,0 | 20,0 | 3/4"   | 1 1/2" | Ø54/50 | 0,320      |
| RFF 40-25 | 39,0 | 20,0 | 1"     | 1 1/2" | Ø54/50 | 0,255      |
| RFF 40-32 | 39,0 | 20,0 | 1 1/4" | 1 1/2" | Ø54/50 | 0,195      |
| RFF 50-20 | 43,0 | 20,0 | 3/4"   | 2"     | Ø70/60 | 0,646      |
| RFF 50-25 | 43,0 | 20,0 | 1"     | 2"     | Ø70/60 | 0,588      |
| RFF 50-32 | 43,0 | 20,0 | 1 1/4" | 2"     | Ø70/60 | 0,500      |
| RFF 50-40 | 43,0 | 20,0 | 1 1/2" | 2"     | Ø70/60 | 0,418      |

Ø Pièces fabriquées a partir de rond ou d'ébauche cylindrique (voir photo)

Informations techniques et illustrations fournies à titre indicatif et susceptibles de modifications.